

16th Annual
ARCHITECTURAL GUIDELINES
GINGERCANE COMMUNITY



— THE —
GINGERCANE
C O N T E S T
Baking a Difference



“
On the Outskirts of the North Pole,
On a snowy white knoll
Lies the community of GingerCane
That few really know.
Inspired by sweetness and gingerbread bits,
This candy-colored enclave is one you don't want to miss.
Houses styled full of gum-drops and glee
Gives residents an exclusive sweet-tooth community.”

Introduction

This highly prominent and sought-after elf community is a mixed use site, seamlessly blending the joy of Christmas and the bliss of work. Conveniently located near the toy factory and surrounded by open reindeer spaces and Cheer Parks, GingerCane is the ideal live work community for the most ambitious elf families valuing the idyllic 95:5 work, life balance; for every elf loves to work. Work is their favorite!

Elf Hack

Every team gets a customized link to their voting page, so spamming your contact list is as easy as ginger pie

Easy as 1-2-3!

DESIGN

Assemble your team & reserve your lot at gingercane.com. Put your egg-noggins together to come up with a design or theme.

BUILD

Gather your construction team, the tall and the small & build, Build, BUILD! Upload photos & video of your process and creation to your page.

PROMOTE

Email, text, call and telegram everyone you know Inviting them to donate! Every dollar for the elf girls and boys counts as a vote for your team. Help Bake a Difference!



Elf Hack

Melted blue Jolly Ranchers make for a tasty, glistening frozen lake or frosty windows

MATERIALS

Materials will need to withstand harsh winters and exhibit the cheerful “anything goes” philosophy of GingerCane.

The five main building elements are recommended but not limited to: Candy, Candy Canes, Candy Corns, Gingerbread, and Icing (or PL).

COLOURS

Colours are to be loud and proud, embellished in your true elf spirit. Make sure you're tasting the rainbow.

Elf Hack

“Son of a nutcracker that's a lot of Baking!”

Don't Fret, Rice Krispies make a quick, alternative. No Oven required





Architectural Style

All homes in GingerCane are to be of a temptingly sweetened aesthetic utilizing unbounded creativity and imagination. The Architectural style of GingerCane establishes a strong character by mixing the traditional gingerbread styles with modern, whimsical influences, while expressing the vision, spirit and sweet tooth of its designers.

Designers are encouraged to include a multitude of details following the words of famous architect Mies van der Snow, "**More is More**".



CRAFT COTTAGE



URBAN GINGER



SWEET VICTORIAN

Elf Hack

Don't be a cotton-headed ninny muggins! Your foundation doesn't need to be edible. A strong foundation is the best foundation.

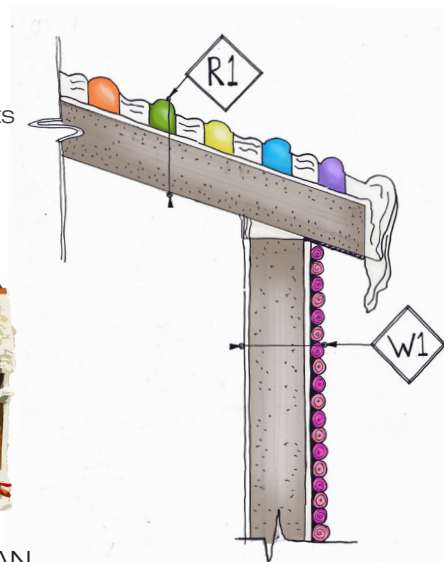

Elf Hack

Hot glue or PL make
a quick, long-lasting
replacement to icing



Site Planning

HOUSE SIZES

There's no house too small or too tall, but it
better bring holiday cheer to all.

SITING AND SETBACKS

Setbacks are governed by the requirements
as per The North Pole bylaws set out by
administration elves.

HIGH VISIBILITY LOTS

All lots are high exposure lots! Audacious
detailing on all elevations grabbing attention
and causing reflexive drooling from all its
delicious sweetness.

Each December, E2 + Associates presents the annual 'GingerCane' Gingerbread House Design Contest that brings together the home building industry in support of innovative programs, life-saving equipment and leading-edge research for kids.

e2+associates
LAND ADVISORY GROUP

www.e2.associates
ORGANIZED BY: E2 + Associates
Calgary, AB CANADA | 403.256.5123

